



FOR LEASE

4600 Cromwell

4600 Cromwell / Memphis, TN 38118

Southeast Submarket

9 DOCK DOORS
25,554 SF



Industrial Space For Lease 25,554 SF Available

Property Highlights

- 9 dock high doors
- Front park & rear loading
- 22' clear height
- 50' x 50' column spacing
- 4,589 SF office



Kemp Conrad, SIOR,
Dual Designation
Principal
901 273 2359
kconrad@commadv.com

Jeb Fields, SIOR, CCIM
Executive VP, Principal
901 362 4315
jfields@commadv.com

Owen Mercer
Associate
901 273 2343
omercer@commadv.com

5101 Wheelis Drive, Suite 300
Memphis, TN 38117
Main: 901 683 0808
www.commadv.com

Independently Owned and Operated / A Member of the Cushman & Wakefield Alliance

Cushman & Wakefield Copyright 2015. No warranty or representation, express or implied, is made to the accuracy or completeness of the information contained herein, and same is submitted subject to errors, omissions, change of price, rental or other conditions, withdrawal without notice, and to any special listing conditions imposed by the property owner(s). As applicable, we make no representation as to the condition of the property (or properties) in question.



FOR LEASE

4600 Cromwell

4600 Cromwell / Memphis, TN 38118
Southeast Submarket

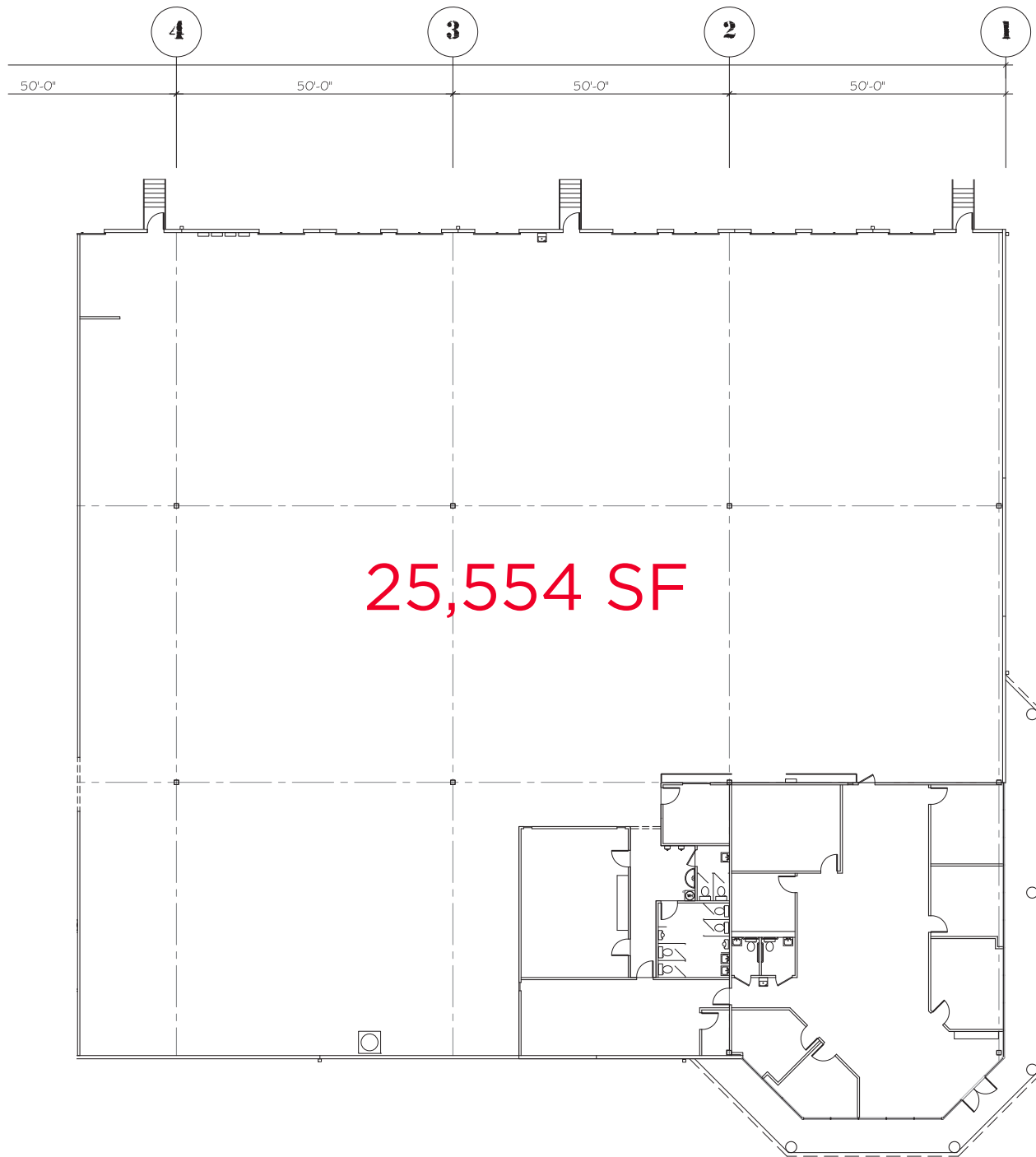

Kemp Conrad, SIOR,
Dual Designation
 Principal
 901 273 2359
 kconrad@commadv.com

Jeb Fields, SIOR, CCIM
 Executive VP, Principal
 901 362 4315
 jfields@commadv.com

Owen Mercer
 Associate
 901 273 2343
 omercer@commadv.com

5101 Wheelis Drive, Suite 300
 Memphis, TN 38117
 Main: 901 683 0808
www.commadv.com

Independently Owned and Operated / A Member of the Cushman & Wakefield Alliance

Cushman & Wakefield Copyright 2015. No warranty or representation, express or implied, is made to the accuracy or completeness of the information contained herein, and same is submitted subject to errors, omissions, change of price, rental or other conditions, withdrawal without notice, and to any special listing conditions imposed by the property owner(s). As applicable, we make no representation as to the condition of the property (or properties) in question.