



AVAILABLE

Shelby Oaks Industrial Park

1751 Shelby Oaks Drive, Memphis, TN
Northeast Submarket



Available: 44,820 SF Stand-Alone Building

Property Highlights

- 7 dock doors
- 24' clear ceiling height
- Column spacing: 50' x 50'
- Fenced, secure truck court
- 0.42/2,400 SF sprinkler density

Building Features

Total Available	44,820 SF (Available)
Office SF	4,000 +/- SF



Kemp Conrad, SIOR,
Dual Designation
Principal
901 273 2359
kconrad@commadv.com

Jeb Fields, SIOR, CCIM
Executive VP, Principal
901 362 4315
jfields@commadv.com

Owen Mercer
Associate
901 273 2343
omercer@commadv.com

5101 Wheelis Drive, Suite 300
Memphis, TN 38117
Main: 901 683 0808
www.commadv.com

Independently Owned and Operated / A Member of the Cushman & Wakefield Alliance

Cushman & Wakefield Copyright 2015. No warranty or representation, express or implied, is made to the accuracy or completeness of the information contained herein, and same is submitted subject to errors, omissions, change of price, rental or other conditions, withdrawal without notice, and to any special listing conditions imposed by the property owner(s). As applicable, we make no representation as to the condition of the property (or properties) in question.



AVAILABLE

Shelby Oaks Industrial Park

1751 Shelby Oaks Drive, Memphis, TN
Northeast Submarket

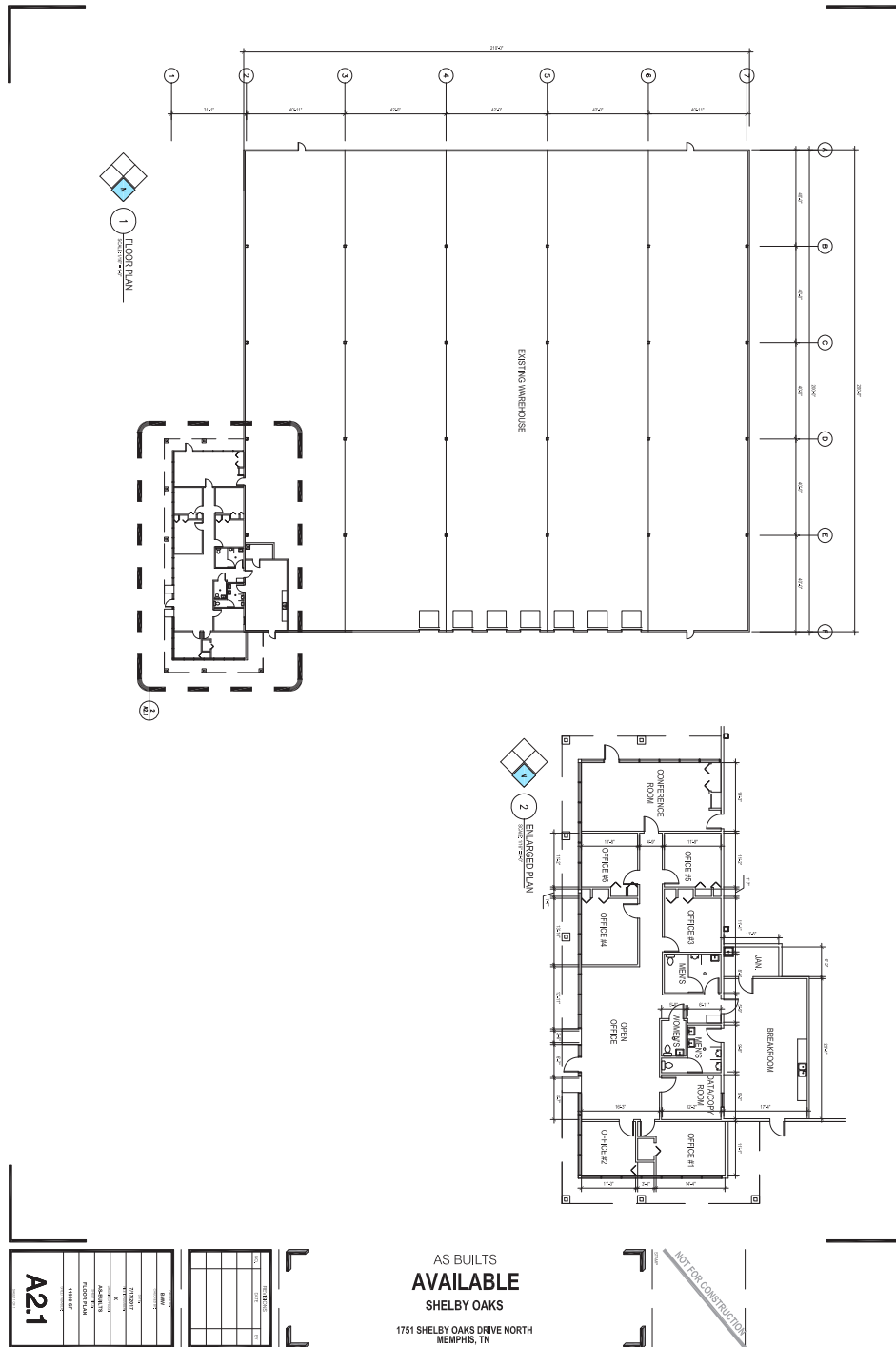

Kemp Conrad, SIOR,
Dual Designation
Principal
901 273 2359
kconrad@commadv.com

Jeb Fields, SIOR, CCIM
Executive VP, Principal
901 362 4315
jfields@commadv.com

Owen Mercer
Associate
901 273 2343
omercer@commadv.com

5101 Wheelis Drive, Suite 300
Memphis, TN 38117
Main: 901 683 0808
www.commadv.com

Independently Owned and Operated / A Member of the Cushman & Wakefield Alliance

Cushman & Wakefield Copyright 2015. No warranty or representation, express or implied, is made to the accuracy or completeness of the information contained herein, and same is submitted subject to errors, omissions, change of price, rental or other conditions, withdrawal without notice, and to any special listing conditions imposed by the property owner(s). As applicable, we make no representation as to the condition of the property (or properties) in question.