



FOR LEASE

Century Center Business Park

1590 Century Center Parkway / Memphis, TN
Northeast Submarket

24' CLEAR HEIGHT

BUILDING A



Space Available: 23,750 SF

Property Highlights

- Ideal location for both local and regional distribution
- Immediate access to major state highways
- Access to a large and diverse labor pool
- Direct access to a variety of amenities
- 24' clear height
- 50' x 50' column spacing
- Class III fire sprinkler
- Front load dock package
- 2 drive-in doors
- Ample car parking
- 2 docks



Bentley Pembroke, SIOR
Vice President
901 362 3599
bpembroke@commadv.com

5101 Wheelis Drive, Suite 320
Memphis, TN 38117
Main: 901 683 0808
www.commadv.com

Independently Owned and Operated / A Member of the Cushman & Wakefield Alliance

Cushman & Wakefield Copyright 2015. No warranty or representation, express or implied, is made to the accuracy or completeness of the information contained herein, and same is submitted subject to errors, omissions, change of price, rental or other conditions, withdrawal without notice, and to any special listing conditions imposed by the property owner(s). As applicable, we make no representation as to the condition of the property (or properties) in question.

Site Plan



Building Features

Total Building	118,000 SF
Total Available	23,750 SF (divisible)
Total Office	approx. 2,500 +/- SF

Stacking Plan

23,750 SF

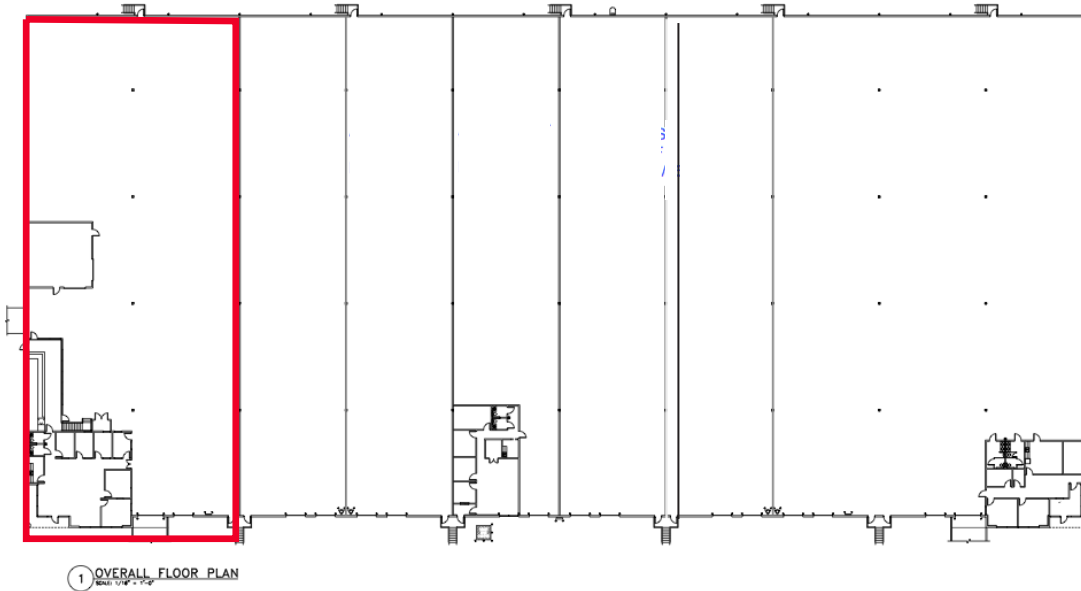

1 OVERALL FLOOR PLAN
Scale: 1/8" = 1'-0"

Bentley Pembroke, SIOR
Vice President
901 362 3599
bpembroke@commadv.com

5101 Wheelis Drive, Suite 320
Memphis, TN 38117
Main: 901 683 0808
www.commadv.com

Independently Owned and Operated / A Member of the Cushman & Wakefield Alliance

Cushman & Wakefield Copyright 2015. No warranty or representation, express or implied, is made to the accuracy or completeness of the information contained herein, and same is submitted subject to errors, omissions, change of price, rental or other conditions, withdrawal without notice, and to any special listing conditions imposed by the property owner(s). As applicable, we make no representation as to the condition of the property (or properties) in question.